

16 DNH Absorption Chiller (High Efficiency)

Keep on building our PRIDE

ONLY through the TRUST



Have ALWAYS been right behind the MIRACLE

CLK Corporation

(Carrier Limited Korea)

8th~9th Floor, E.C.F.C. Building, 19-7, Nonhyun-dong, Gangnam-gu Seoul, Korea [135-010]

Telephone: +82-2-3441-2586, 8850, 2582 / Fax: +82-2-544-2583 / E-mail: OverseasSales@carrier.co.kr

16 DNH Absorption Chiller – 100 usRT

- Model : **16DNH010 (100 usRT)**
- Dimension(Length x Width x Height)
 - 2,801 x 1,797 x 2,081 mm
- Net Weight : 5,050 kg
- Features
 - Alternative-energy chiller/heater
 - Direct-fired, high-efficiency and double effect absorption cooling cycle
 - Superior part-load performance
 - Operation in the heating mode for additional savings
 - Ideal for new or retrofit applications
 - Combined use of absorption and electric-driven chillers
 - Employment of **SVEP**'s plate type heat exchanger for high efficiency

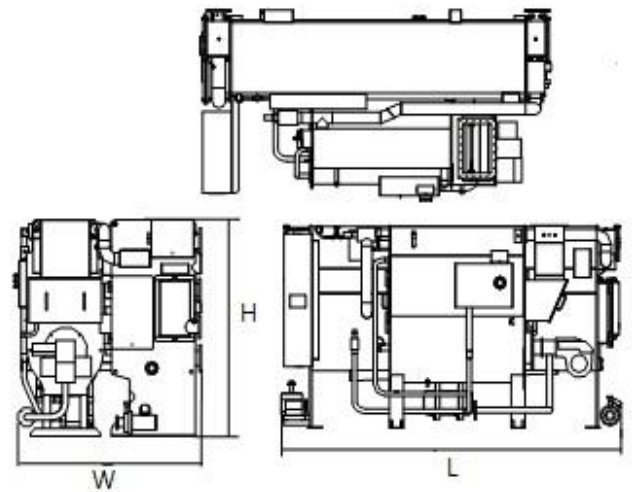

Specification

Cooling Capacity		kW	352
Heating Capacity		kW	250
Chilled Water	Flow Rate	l/sec	15.1
	Pressure Drop	kPa	58.5
Cooling Water	Flow Rate	l/sec	25.3
	Pressure Drop	kPa	42.0
Hot Water	Flow Rate	l/sec	12.3
	Pressure Drop	kPa	34.8
Fuel Consumption	Natural Gas	m ³ /hr.	28.0
	No. 2 Oil	l/hr.	26.8
Coefficient of Performance(COP)	Natural Gas	-	1.33
	No. 2 Oil	-	1.33
Rigging Weight	Absorber/Evaporator/ G2/ Condenser	kg	3,090
	G1 (Includes Burner)	kg	1,170
	LiBr Solution Charge	kg	640
	Refrigerant(Water) Charge	kg	150
	Total	kg	5,050
Operating Weight		kg	5,450
Chilled/Hot Water (Evap.)	Pipe Connection Size	in	4
	No. Passes	-	4
Cooling Water	Pipe Connection Size	in	5
	No. Passes	Absorber	3
		Condenser	1
Gas-Train Inlet	Standard Pipe Connection Size	in	1.5
Exhaust Gas Outlet	Nominal Flange Connection Size	mm	400 x 232

- Note)**
1. G1-High Temperature Generator, G2-Low Temperature Generator
 2. Ratings are based on ARI 560, latest edition, 12.2/6.7 C (.043 L/s-kW) chilled water; 29.4 C (.072 L/s-kW) cooling water; 54.4/60C hot water; fouling factor. 000044 m²-hr-°C/W for absorber and condenser, .0000176 m²-hr-°C/W for evaporator; natural gas heating value 8899 kcal/m³ (LHV); No 2 oil heating value 9320 kcal/L Higher Heating Capacity is available.
 3. Specifications are subject to change.

16 DNH Absorption Chiller – 120 usRT

- Model : **16DNH012 (120 usRT)**
- Dimension(Length x Width x Height)
 - 2,801 x 1,797 x 2,081 mm
- Net Weight : 5,370 kg
- Features
 - Alternative-energy chiller/heater
 - Direct-fired, high-efficiency and double effect absorption cooling cycle
 - Superior part-load performance
 - Operation in the heating mode for additional savings
 - Ideal for new or retrofit applications
 - Combined use of absorption and electric-driven chillers
 - Employment of **SVEP**'s plate type heat exchanger for high efficiency

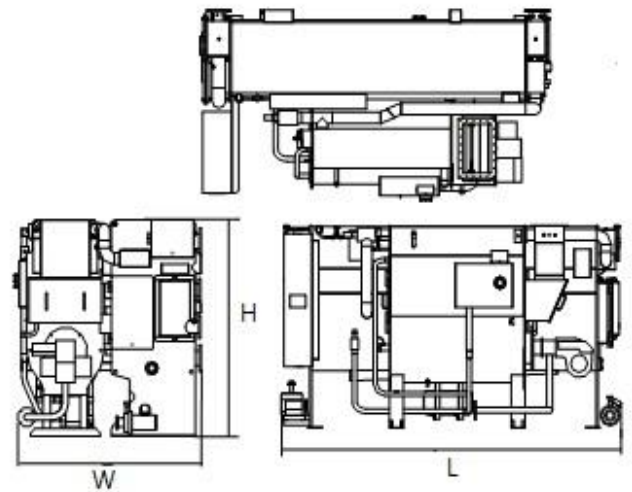

Specification

Cooling Capacity		kW	422
Heating Capacity		kW	300
Chilled Water	Flow Rate	ℓ/sec	18.1
	Pressure Drop	kPa	63.4
Cooling Water	Flow Rate	ℓ/sec	30.4
	Pressure Drop	kPa	46.1
Hot Water	Flow Rate	ℓ/sec	14.8
	Pressure Drop	kPa	38.4
Fuel Consumption	Natural Gas	m ³ /hr.	33.7
	No. 2 Oil	ℓ/hr.	32.2
Coefficient of Performance(COP)	Natural Gas	-	1.33
	No. 2 Oil	-	1.33
Rigging Weight	Absorber/Evaporator/ G2/ Condenser	kg	3,210
	G1 (Includes Burner)	kg	1,330
	LiBr Solution Charge	kg	690
	Refrigerant (Water) Charge	kg	140
	Total	kg	5,370
Operating Weight		kg	5,820
Chilled/Hot Water (Evap.)	Pipe Connection Size	in	4
	No. Passes	-	4
Cooling Water	Pipe Connection Size	in	5
	No. Passes	Absorber	3
		Condenser	1
Gas-Train Inlet	Standard Pipe Connection Size	in	1.5
Exhaust Gas Outlet	Nominal Flange Connection Size	mm	400 x 232

- Note)**
1. G1-High Temperature Generator, G2-Low Temperature Generator
 2. Ratings are based on ARI 560, latest edition, 12.2/6.7 C (.043 L/s-kW) chilled water; 29.4 C (.072 L/s-kW) cooling water; 54.4/60C hot water; fouling factor. 000044 m²-hr-°C/W for absorber and condenser, .0000176 m²-hr-°C/W for evaporator; natural gas heating value 8899 kcal/m³ (LHV); No 2 oil heating value 9320 kcal/L Higher Heating Capacity is available.
 3. Specifications are subject to change.

16 DNH Absorption Chiller – 150 usRT

- Model : **16DNH015 (150 usRT)**
- Dimension(Length x Width x Height)
 - 3,644 x 1,829 x 2,056 mm
- Net Weight : 6,330 kg
- Features
 - Alternative-energy chiller/heater
 - Direct-fired, high-efficiency and double effect absorption cooling cycle
 - Superior part-load performance
 - Operation in the heating mode for additional savings
 - Ideal for new or retrofit applications
 - Combined use of absorption and electric-driven chillers
 - Employment of **SVEP**'s plate type heat exchanger for high efficiency

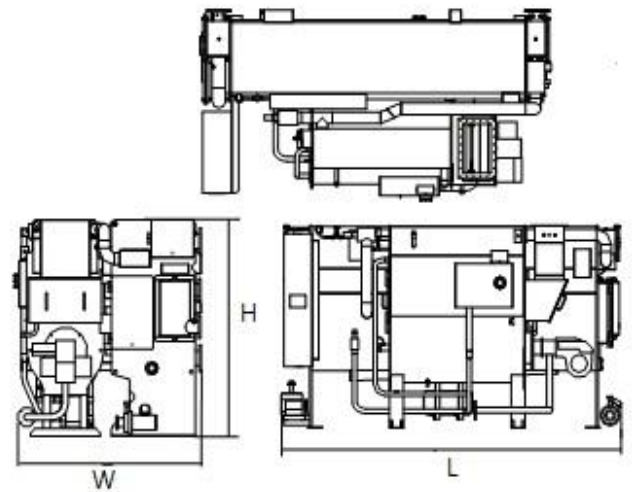

Specification

Cooling Capacity		kW	528
Heating Capacity		kW	375
Chilled Water	Flow Rate	l/sec	22.7
	Pressure Drop	kPa	75.0
Cooling Water	Flow Rate	l/sec	37.9
	Pressure Drop	kPa	63.6
Hot Water	Flow Rate	l/sec	18.4
	Pressure Drop	kPa	44.1
Fuel Consumption	Natural Gas	m ³ /hr.	42.2
	No. 2 Oil	l/hr.	40.2
Coefficient of Performance(COP)	Natural Gas	-	1.33
	No. 2 Oil	-	1.33
Rigging Weight	Absorber/Evaporator/ G2/ Condenser	kg	3,820
	G1 (Includes Burner)	kg	1,420
	LiBr Solution Charge	kg	860
	Refrigerant (Water) Charge	kg	230
	Total	kg	6,330
Operating Weight		kg	6,840
Chilled/Hot Water (Evap.)	Pipe Connection Size	in	4
	No. Passes	-	3
Cooling Water	Pipe Connection Size	in	5
	No. Passes	Absorber	2
		Condenser	1
Gas-Train Inlet	Standard Pipe Connection Size	in	1.5
Exhaust Gas Outlet	Nominal Flange Connection Size	mm	485 x 290

- Note)**
1. G1-High Temperature Generator, G2-Low Temperature Generator
 2. Ratings are based on ARI 560, latest edition, 12.2/6.7 C (.043 L/s-kW) chilled water; 29.4 C (.072 L/s-kW) cooling water; 54.4/60C hot water; fouling factor. 000044 m²-hr-°C/W for absorber and condenser, .0000176 m²-hr-°C/W for evaporator; natural gas heating value 8899 kcal/m³ (LHV); No 2 oil heating value 9320 kcal/L Higher Heating Capacity is available.
 3. Specifications are subject to change.

16 DNH Absorption Chiller – 180 usRT

- Model : **16DNH018 (180 usRT)**
- Dimension(Length x Width x Height)
 - 3,644 x 1,829 x 2,056 mm
- Net Weight : 6,710 kg
- Features
 - Alternative-energy chiller/heater
 - Direct-fired, high-efficiency and double effect absorption cooling cycle
 - Superior part-load performance
 - Operation in the heating mode for additional savings
 - Ideal for new or retrofit applications
 - Combined use of absorption and electric-driven chillers
 - Employment of **SUPER**'s plate type heat exchanger for high efficiency

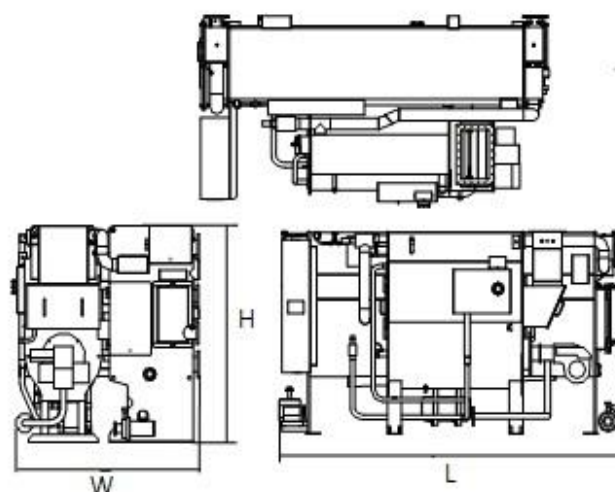

Specification

Cooling Capacity		kW	633
Heating Capacity		kW	450
Chilled Water	Flow Rate	l/sec	27.3
	Pressure Drop	kPa	81.2
Cooling Water	Flow Rate	l/sec	45.4
	Pressure Drop	kPa	72.9
Hot Water	Flow Rate	l/sec	22.1
	Pressure Drop	kPa	48.6
Fuel Consumption	Natural Gas	m ³ /hr.	50.6
	No. 2 Oil	l/hr.	48.2
Coefficient of Performance(COP)	Natural Gas	-	1.33
	No. 2 Oil	-	1.33
Rigging Weight	Absorber/Evaporator/ G2/ Condenser	kg	4,060
	G1 (Includes Burner)	kg	1,470
	LiBr Solution Charge	kg	950
	Refrigerant (Water) Charge	kg	230
	Total	kg	6,710
Operating Weight		kg	7,280
Chilled/Hot Water (Evap.)	Pipe Connection Size	in	4
	No. Passes	-	3
Cooling Water	Pipe Connection Size	in	5
	No. Passes	Absorber	2
		Condenser	1
Gas-Train Inlet	Standard Pipe Connection Size	in	1.5
Exhaust Gas Outlet	Nominal Flange Connection Size	mm	485 x 290

- Note)**
1. G1-High Temperature Generator, G2-Low Temperature Generator
 2. Ratings are based on ARI 560, latest edition, 12.2/6.7 C (.043 L/s-kW) chilled water; 29.4 C (.072 L/s-kW) cooling water; 54.4/60C hot water; fouling factor. 000044 m²-hr-°C/W for absorber and condenser, .0000176 m²-hr-°C/W for evaporator; natural gas heating value 8899 kcal/m³ (LHV); No 2 oil heating value 9320 kcal/L Higher Heating Capacity is available.
 3. Specifications are subject to change.

16 DNH Absorption Chiller – 210 usRT

- Model : **16DNH021 (210 usRT)**
- Dimension(Length x Width x Height)
 - 3,679 x 2,034 x 2,312 mm
- Net Weight : 7,730 kg
- Features
 - Alternative-energy chiller/heater
 - Direct-fired, high-efficiency and double effect absorption cooling cycle
 - Superior part-load performance
 - Operation in the heating mode for additional savings
 - Ideal for new or retrofit applications
 - Combined use of absorption and electric-driven chillers
 - Employment of **SVEP**'s plate type heat exchanger for high efficiency

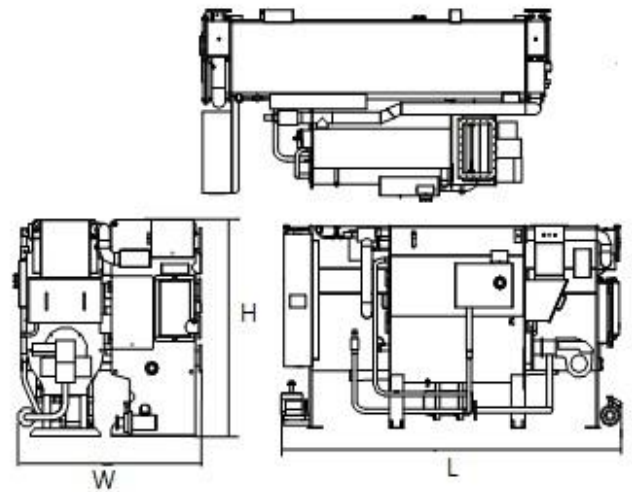

Specification

Cooling Capacity		kW	739
Heating Capacity		kW	525
Chilled Water	Flow Rate	l/sec	31.8
	Pressure Drop	kPa	77.9
Cooling Water	Flow Rate	l/sec	53.0
	Pressure Drop	kPa	51.3
Hot Water	Flow Rate	l/sec	25.8
	Pressure Drop	kPa	45.6
Fuel Consumption	Natural Gas	m ³ /hr.	59.0
	No. 2 Oil	l/hr.	56.3
Coefficient of Performance(COP)	Natural Gas	-	1.33
	No. 2 Oil	-	1.33
Rigging Weight	Absorber/Evaporator/ G2/ Condenser	kg	4,650
	G1 (Includes Burner)	kg	1,620
	LiBr Solution Charge	kg	1,150
	Refrigerant (Water) Charge	kg	310
	Total	kg	7,730
Operating Weight		kg	8,450
Chilled/Hot Water (Evap.)	Pipe Connection Size	in	5
	No. Passes	-	3
Cooling Water	Pipe Connection Size	in	6
	No. Passes	Absorber	2
		Condenser	1
Gas-Train Inlet	Standard Pipe Connection Size	in	1.5
Exhaust Gas Outlet	Nominal Flange Connection Size	mm	600 x 290

- Note)**
1. G1-High Temperature Generator, G2-Low Temperature Generator
 2. Ratings are based on ARI 560, latest edition, 12.2/6.7 C (.043 L/s-kW) chilled water; 29.4 C (.072 L/s-kW) cooling water; 54.4/60C hot water; fouling factor. 000044 m²-hr-°C/W for absorber and condenser, .0000176 m²-hr-°C/W for evaporator; natural gas heating value 8899 kcal/m³ (LHV); No 2 oil heating value 9320 kcal/L Higher Heating Capacity is available.
 3. Specifications are subject to change.

16 DNH Absorption Chiller – 240 usRT

- Model : **16DNH024 (240 usRT)**
- Dimension (Length x Width x Height)
 - 3,679 x 2,034 x 2,312 mm
- Net Weight : 8,300 kg
- Features
 - Alternative-energy chiller/heater
 - Direct-fired, high-efficiency and double effect absorption cooling cycle
 - Superior part-load performance
 - Operation in the heating mode for additional savings
 - Ideal for new or retrofit applications
 - Combined use of absorption and electric-driven chillers
 - Employment of **SVEP**'s plate type heat exchanger for high efficiency

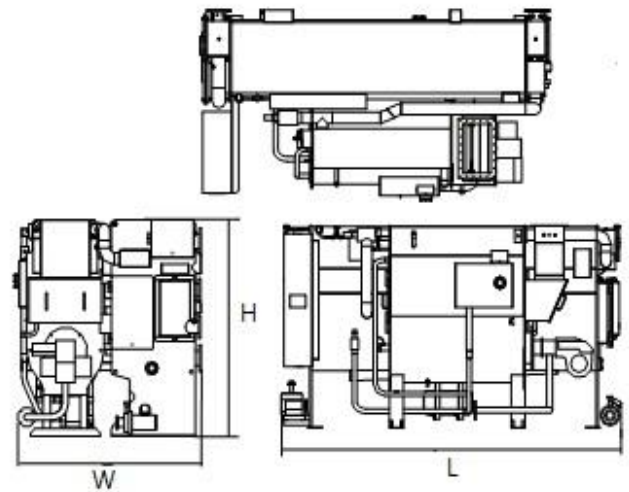

Specification

Cooling Capacity		kW	844
Heating Capacity		kW	600
Chilled Water	Flow Rate	l/sec	36.3
	Pressure Drop	kPa	79.7
Cooling Water	Flow Rate	l/sec	60.6
	Pressure Drop	kPa	57.0
Hot Water	Flow Rate	l/sec	29.5
	Pressure Drop	kPa	47.3
Fuel Consumption	Natural Gas	m ³ /hr.	67.4
	No. 2 Oil	l/hr.	64.4
Coefficient of Performance (COP)	Natural Gas	-	1.33
	No. 2 Oil	-	1.33
Rigging Weight	Absorber/Evaporator/ G2/ Condenser	kg	4,960
	G1 (Includes Burner)	kg	1,830
	LiBr Solution Charge	kg	1,210
	Refrigerant (Water) Charge	kg	300
	Total	kg	8,300
Operating Weight		kg	9,100
Chilled/Hot Water (Evap.)	Pipe Connection Size	in	5
	No. Passes	-	3
Cooling Water	Pipe Connection Size	in	6
	No. Passes	Absorber	2
		Condenser	1
Gas-Train Inlet	Standard Pipe Connection Size	in	2
Exhaust Gas Outlet	Nominal Flange Connection Size	mm	600 x 290

- Note)**
1. G1-High Temperature Generator, G2-Low Temperature Generator
 2. Ratings are based on ARI 560, latest edition, 12.2/6.7 C (.043 L/s-kW) chilled water; 29.4 C (.072 L/s-kW) cooling water; 54.4/60C hot water; fouling factor. 000044 m²-hr-°C/W for absorber and condenser, .0000176 m²-hr-°C/W for evaporator; natural gas heating value 8899 kcal/m³ (LHV); No 2 oil heating value 9320 kcal/L Higher Heating Capacity is available.
 3. Specifications are subject to change.

16 DNH Absorption Chiller – 280 usRT

- Model : **16DNH028 (280 usRT)**
- Dimension (Length x Width x Height)
 - 4,780 x 2,077 x 2,381 mm
- Net Weight : 10,200 kg
- Features
 - Alternative-energy chiller/heater
 - Direct-fired, high-efficiency and double effect absorption cooling cycle
 - Superior part-load performance
 - Operation in the heating mode for additional savings
 - Ideal for new or retrofit applications
 - Combined use of absorption and electric-driven chillers
 - Employment of **SVEP**'s plate type heat exchanger for high efficiency

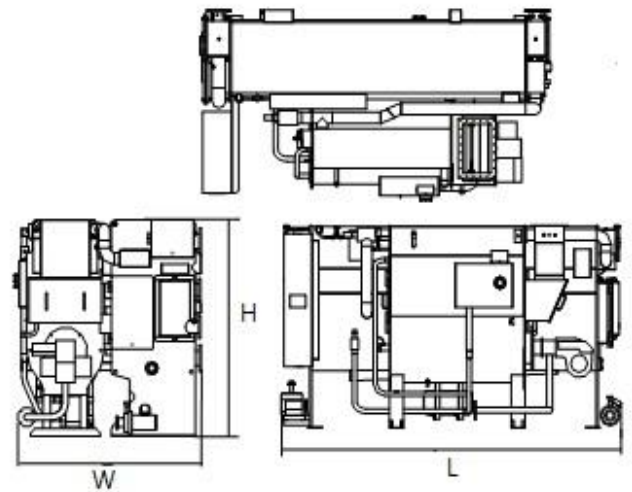

Specification

Cooling Capacity		kW	985
Heating Capacity		kW	700
Chilled Water	Flow Rate	l/sec	42.4
	Pressure Drop	kPa	52.4
Cooling Water	Flow Rate	l/sec	70.7
	Pressure Drop	kPa	77.8
Hot Water	Flow Rate	l/sec	34.4
	Pressure Drop	kPa	30.6
Fuel Consumption	Natural Gas	m ³ /hr.	78.6
	No. 2 Oil	l/hr.	75.1
Coefficient of Performance(COP)	Natural Gas	-	1.33
	No. 2 Oil	-	1.33
Rigging Weight	Absorber/Evaporator/ G2/ Condenser	kg	6,000
	G1 (Includes Burner)	kg	2,060
	LiBr Solution Charge	kg	1,700
	Refrigerant (Water) Charge	kg	440
	Total	kg	10,200
Operating Weight		kg	11,150
Chilled/Hot Water (Evap.)	Pipe Connection Size	in	6
	No. Passes	-	2
Cooling Water	Pipe Connection Size	in	8
	No. Passes	Absorber	2
		Condenser	1
Gas-Train Inlet	Standard Pipe Connection Size	in	1.5
Exhaust Gas Outlet	Nominal Flange Connection Size	mm	600 x 290

- Note)**
1. G1-High Temperature Generator, G2-Low Temperature Generator
 2. Ratings are based on ARI 560, latest edition, 12.2/6.7 C (.043 L/s-kW) chilled water; 29.4 C (.072 L/s-kW) cooling water; 54.4/60C hot water; fouling factor. 000044 m²-hr-°C/W for absorber and condenser, .0000176 m²-hr-°C/W for evaporator; natural gas heating value 8899 kcal/m³ (LHV); No 2 oil heating value 9320 kcal/L Higher Heating Capacity is available.
 3. Specifications are subject to change.

16 DNH Absorption Chiller – 330 usRT

- Model : **16DNH033 (330 usRT)**
 - Dimension(Length x Width x Height)
 - 4,780 x 2,077 x 2,381 mm
 - Net Weight : 10,740 kg
 - Features
 - Alternative-energy chiller/heater
 - Direct-fired, high-efficiency and double effect absorption cooling cycle
 - Superior part-load performance
 - Operation in the heating mode for additional savings
 - Ideal for new or retrofit applications
 - Combined use of absorption and electric-driven chillers
- Employment of **SVEP**'s plate type heat exchanger for high efficiency

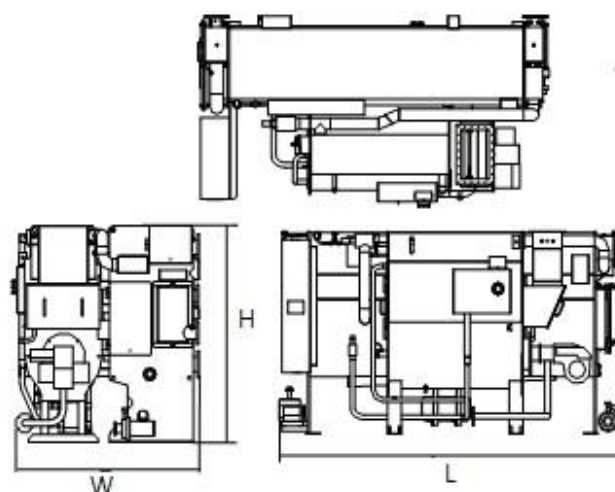

Specification

Cooling Capacity		kW	1161
Heating Capacity		kW	825
Chilled Water	Flow Rate	l/sec	50.0
	Pressure Drop	kPa	54.9
Cooling Water	Flow Rate	l/sec	83.3
	Pressure Drop	kPa	83.0
Hot Water	Flow Rate	l/sec	40.6
	Pressure Drop	kPa	32.6
Fuel Consumption	Natural Gas	m ³ /hr.	92.7
	No. 2 Oil	l/hr.	88.5
Coefficient of Performance(COP)	Natural Gas	-	1.33
	No. 2 Oil	-	1.33
Rigging Weight	Absorber/Evaporator/ G2/ Condenser	kg	6,230
	G1 (Includes Burner)	kg	2,300
	LiBr Solution Charge	kg	1,780
	Refrigerant (Water) Charge	kg	430
	Total	kg	10,740
Operating Weight		kg	11,800
Chilled/Hot Water (Evap.)	Pipe Connection Size	in	6
	No. Passes	-	2
Cooling Water	Pipe Connection Size	in	8
	No. Passes	Absorber	2
		Condenser	1
Gas-Train Inlet	Standard Pipe Connection Size	in	1.5
Exhaust Gas Outlet	Nominal Flange Connection Size	mm	600 x 290

- Note)**
1. G1-High Temperature Generator, G2-Low Temperature Generator
 2. Ratings are based on ARI 560, latest edition, 12.2/6.7 C (.043 L/s-kW) chilled water; 29.4 C (.072 L/s-kW) cooling water; 54.4/60C hot water; fouling factor. 000044 m²-hr-°C/W for absorber and condenser, .0000176 m²-hr-°C/W for evaporator; natural gas heating value 8899 kcal/m³ (LHV); No 2 oil heating value 9320 kcal/L Higher Heating Capacity is available.
 3. Specifications are subject to change.

16 DNH Absorption Chiller – 360 usRT

- Model : **16DNH036 (360 usRT)**
- Dimension(Length x Width x Height)
 - 4,798 x 2,298 x 2,630 mm
- Net Weight : 11,650 kg
- Features
 - Alternative-energy chiller/heater
 - Direct-fired, high-efficiency and double effect absorption cooling cycle
 - Superior part-load performance
 - Operation in the heating mode for additional savings
 - Ideal for new or retrofit applications
 - Combined use of absorption and electric-driven chillers
 - Employment of **SUPER**'s plate type heat exchanger for high efficiency

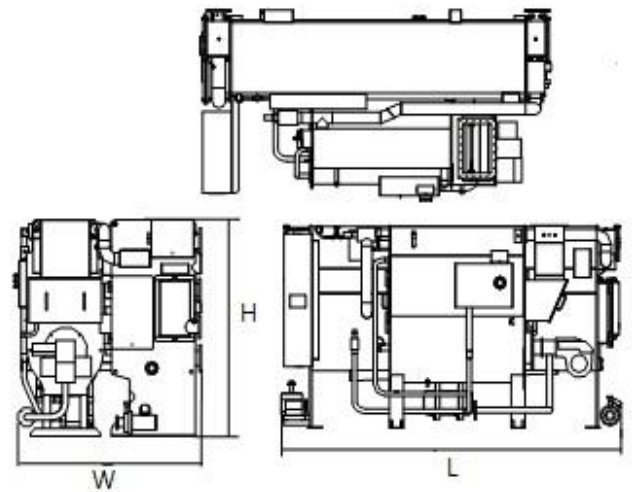

Specification

Cooling Capacity		kW	1,266
Heating Capacity		kW	900
Chilled Water	Flow Rate	l/sec	54.5
	Pressure Drop	kPa	54.2
Cooling Water	Flow Rate	l/sec	90.8
	Pressure Drop	kPa	90.9
Hot Water	Flow Rate	l/sec	44.3
	Pressure Drop	kPa	32.6
Fuel Consumption	Natural Gas	m ³ /hr.	101.1
	No. 2 Oil	l/hr.	96.6
Coefficient of Performance(COP)	Natural Gas	-	1.33
	No. 2 Oil	-	1.33
Rigging Weight	Absorber/Evaporator/ G2/ Condenser	kg	6,690
	G1 (Includes Burner)	kg	2,650
	LiBr Solution Charge	kg	1,800
	Refrigerant (Water) Charge	kg	510
	Total	kg	11,650
Operating Weight		kg	12,920
Chilled/Hot Water (Evap.)	Pipe Connection Size	in	6
	No. Passes	-	2
Cooling Water	Pipe Connection Size	in	8
	No. Passes	Absorber	2
		Condenser	1
Gas-Train Inlet	Standard Pipe Connection Size	in	1.5
Exhaust Gas Outlet	Nominal Flange Connection Size	mm	650 x 348

- Note)**
1. G1-High Temperature Generator, G2-Low Temperature Generator
 2. Ratings are based on ARI 560, latest edition, 12.2/6.7 C (.043 L/s-kW) chilled water; 29.4 C (.072 L/s-kW) cooling water; 54.4/60C hot water; fouling factor. 000044 m²-hr-°C/W for absorber and condenser, .0000176 m²-hr-°C/W for evaporator; natural gas heating value 8899 kcal/m³ (LHV); No 2 oil heating value 9320 kcal/L Higher Heating Capacity is available.
 3. Specifications are subject to change.

16 DNH Absorption Chiller – 400 usRT

- Model : **16DNH040 (400 usRT)**
- Dimension(Length x Width x Height)
 - 4,798 x 2,298 x 2,630 mm
- Net Weight : 12,560 kg
- Features
 - Alternative-energy chiller/heater
 - Direct-fired, high-efficiency and double effect absorption cooling cycle
 - Superior part-load performance
 - Operation in the heating mode for additional savings
 - Ideal for new or retrofit applications
 - Combined use of absorption and electric-driven chillers
 - Employment of **SVEP**'s plate type heat exchanger for high efficiency

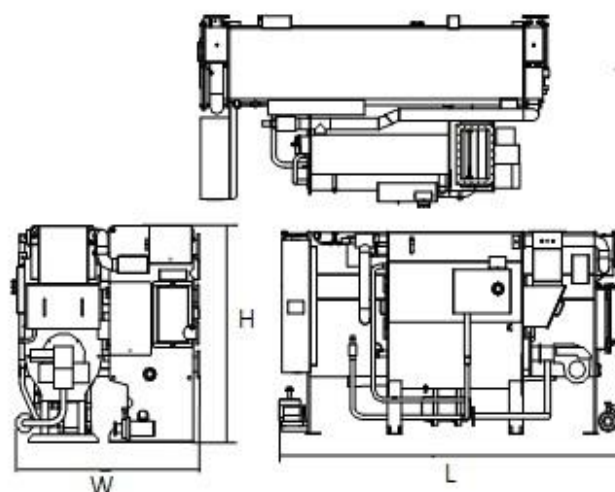

Specification

Cooling Capacity		kW	1,407
Heating Capacity		kW	1,000
Chilled Water	Flow Rate	l/sec	60.6
	Pressure Drop	kPa	55.7
Cooling Water	Flow Rate	l/sec	100.9
	Pressure Drop	kPa	95.2
Hot Water	Flow Rate	l/sec	49.2
	Pressure Drop	kPa	34.1
Fuel Consumption	Natural Gas	m ³ /hr.	112.4
	No. 2 Oil	l/hr.	107.3
Coefficient of Performance(COP)	Natural Gas	-	1.33
	No. 2 Oil	-	1.33
Rigging Weight	Absorber/Evaporator/ G2/ Condenser	kg	7,190
	G1 (Includes Burner)	kg	2,970
	LiBr Solution Charge	kg	1,900
	Refrigerant (Water) Charge	kg	500
	Total	kg	12,560
Operating Weight		kg	13,910
Chilled/Hot Water (Evap.)	Pipe Connection Size	in	6
	No. Passes	-	2
Cooling Water	Pipe Connection Size	in	8
	No. Passes	Absorber	2
		Condenser	1
Gas-Train Inlet	Standard Pipe Connection Size	in	1.5
Exhaust Gas Outlet	Nominal Flange Connection Size	mm	650 x 348

- Note)**
1. G1-High Temperature Generator, G2-Low Temperature Generator
 2. Ratings are based on ARI 560, latest edition, 12.2/6.7 C (.043 L/s-kW) chilled water; 29.4 C (.072 L/s-kW) cooling water; 54.4/60C hot water; fouling factor. 000044 m²-hr-°C/W for absorber and condenser, .0000176 m²-hr-°C/W for evaporator; natural gas heating value 8899 kcal/m³ (LHV); No 2 oil heating value 9320 kcal/L Higher Heating Capacity is available.
 3. Specifications are subject to change.

16 DNH Absorption Chiller – 450 usRT

- Model : **16DNH045 (450 usRT)**
- Dimension(Length x Width x Height)
 - 4,867 x 2,444 x 2,820 mm
- Net Weight : 15,470 kg
- Features
 - Alternative-energy chiller/heater
 - Direct-fired, high-efficiency and double effect absorption cooling cycle
 - Superior part-load performance
 - Operation in the heating mode for additional savings
 - Ideal for new or retrofit applications
 - Combined use of absorption and electric-driven chillers
 - Employment of **SVEP**'s plate type heat exchanger for high efficiency

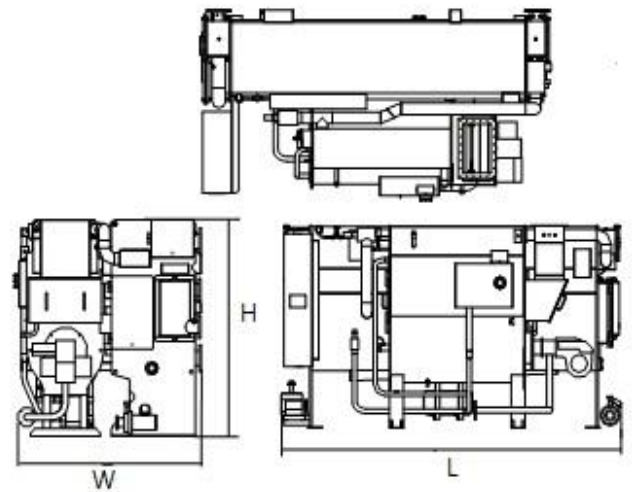

Specification

Cooling Capacity		kW	1,583
Heating Capacity		kW	1,124
Chilled Water	Flow Rate	l/sec	68.1
	Pressure Drop	kPa	54.1
Cooling Water	Flow Rate	l/sec	113.6
	Pressure Drop	kPa	83.9
Hot Water	Flow Rate	l/sec	55.3
	Pressure Drop	kPa	31.1
Fuel Consumption	Natural Gas	m ³ /hr.	126.4
	No. 2 Oil	l/hr.	120.7
Coefficient of Performance(COP)	Natural Gas	-	1.33
	No. 2 Oil	-	1.33
Rigging Weight	Absorber/Evaporator/ G2/ Condenser	kg	8,820
	G1 (Includes Burner)	kg	3,600
	LiBr Solution Charge	kg	2,530
	Refrigerant (Water) Charge	kg	520
	Total	kg	15,470
Operating Weight		kg	17,010
Chilled/Hot Water (Evap.)	Pipe Connection Size	in	8
	No. Passes	-	2
Cooling Water	Pipe Connection Size	in	10
	No. Passes	Absorber	2
		Condenser	1
Gas-Train Inlet	Standard Pipe Connection Size	in	1.5
Exhaust Gas Outlet	Nominal Flange Connection Size	mm	670 x 406

- Note)**
1. G1-High Temperature Generator, G2-Low Temperature Generator
 2. Ratings are based on ARI 560, latest edition, 12.2/6.7 C (.043 L/s-kW) chilled water; 29.4 C (.072 L/s-kW) cooling water; 54.4/60C hot water; fouling factor. 000044 m²-hr-°C/W for absorber and condenser, .0000176 m²-hr-°C/W for evaporator; natural gas heating value 8899 kcal/m³ (LHV); No 2 oil heating value 9320 kcal/L Higher Heating Capacity is available.
 3. Specifications are subject to change.

16 DNH Absorption Chiller – 500 usRT

- Model : **16DNH050 (500 usRT)**
- Dimension(Length x Width x Height)
 - 4,867 x 2,444 x 2,820 mm
- Net Weight : 16,120 kg
- Features
 - Alternative-energy chiller/heater
 - Direct-fired, high-efficiency and double effect absorption cooling cycle
 - Superior part-load performance
 - Operation in the heating mode for additional savings
 - Ideal for new or retrofit applications
 - Combined use of absorption and electric-driven chillers
 - Employment of **SVEP**'s plate type heat exchanger for high efficiency

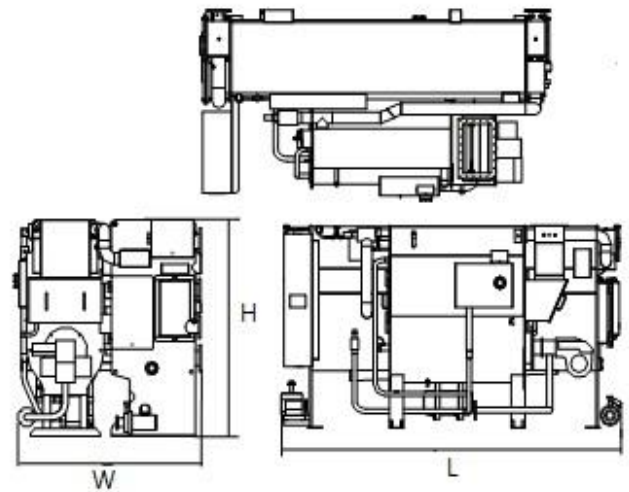

Specification

Cooling Capacity		kW	1,758
Heating Capacity		kW	1,248
Chilled Water	Flow Rate	l/sec	75.7
	Pressure Drop	kPa	54.5
Cooling Water	Flow Rate	l/sec	126.2
	Pressure Drop	kPa	86.8
Hot Water	Flow Rate	l/sec	61.5
	Pressure Drop	kPa	31.6
Fuel Consumption	Natural Gas	m ³ /hr.	140.4
	No. 2 Oil	l/hr.	134.1
Coefficient of Performance(COP)	Natural Gas	-	1.33
	No. 2 Oil	-	1.33
Rigging Weight	Absorber/Evaporator/ G2/ Condenser	kg	8,990
	G1 (Includes Burner)	kg	3,960
	LiBr Solution Charge	kg	2,660
	Refrigerant (Water) Charge	kg	510
	Total	kg	16,120
Operating Weight		kg	17,780
Chilled/Hot Water (Evap.)	Pipe Connection Size	in	8
	No. Passes	-	2
Cooling Water	Pipe Connection Size	in	10
	No. Passes	Absorber	2
		Condenser	1
Gas-Train Inlet	Standard Pipe Connection Size	in	1.5
Exhaust Gas Outlet	Nominal Flange Connection Size	mm	670 x 406

- Note)**
1. G1-High Temperature Generator, G2-Low Temperature Generator
 2. Ratings are based on ARI 560, latest edition, 12.2/6.7 C (.043 L/s-kW) chilled water; 29.4 C (.072 L/s-kW) cooling water; 54.4/60C hot water; fouling factor. 000044 m²-hr-°C/W for absorber and condenser, .0000176 m²-hr-°C/W for evaporator; natural gas heating value 8899 kcal/m³ (LHV); No 2 oil heating value 9320 kcal/L Higher Heating Capacity is available.
 3. Specifications are subject to change.

16 DNH Absorption Chiller – 600 usRT

- Model : **16DNH060 (600 usRT)**
- Dimension(Length x Width x Height)
 - 5,640 x 2,866 x 3,102 mm
- Net Weight : 22,470 kg
- Features
 - Alternative-energy chiller/heater
 - Direct-fired, high-efficiency and double effect absorption cooling cycle
 - Superior part-load performance
 - Operation in the heating mode for additional savings
 - Ideal for new or retrofit applications
 - Combined use of absorption and electric-driven chillers
 - Employment of **SVEP**'s plate type heat exchanger for high efficiency

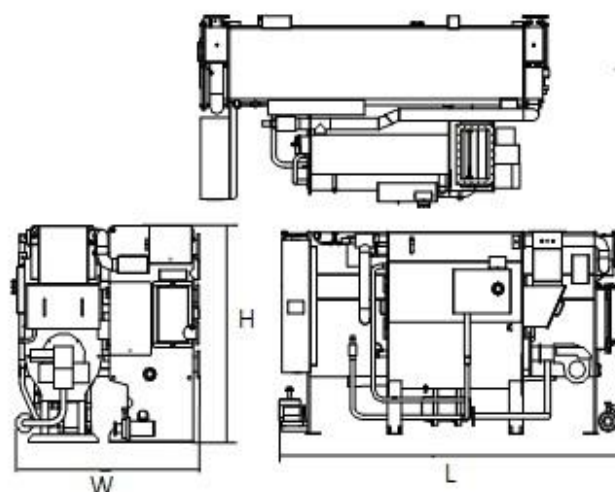

Specification

Cooling Capacity		kW	2,110
Heating Capacity		kW	1,498
Chilled Water	Flow Rate	l/sec	90.7
	Pressure Drop	kPa	48.8
Cooling Water	Flow Rate	l/sec	151.9
	Pressure Drop	kPa	76.3
Hot Water	Flow Rate	l/sec	73.8
	Pressure Drop	kPa	38.0
Fuel Consumption	Natural Gas	m ³ /hr.	168.5
	No. 2 Oil	l/hr.	160.9
Coefficient of Performance(COP)	Natural Gas	-	1.33
	No. 2 Oil	-	1.33
Rigging Weight	Absorber/Evaporator/ G2/ Condenser	kg	13,450
	G1 (Includes Burner)	kg	4,770
	LiBr Solution Charge	kg	3,420
	Refrigerant (Water) Charge	kg	830
	Total	kg	22,470
Operating Weight		kg	24,980
Chilled/Hot Water (Evap.)	Pipe Connection Size	in	8
	No. Passes	-	2
Cooling Water	Pipe Connection Size	in	12
	No. Passes	Absorber	2
		Condenser	1
Gas-Train Inlet	Standard Pipe Connection Size	in	1.5
Exhaust Gas Outlet	Nominal Flange Connection Size	mm	780 x 406

- Note)**
1. G1-High Temperature Generator, G2-Low Temperature Generator
 2. Ratings are based on ARI 560, latest edition, 12.2/6.7 C (.043 L/s-kW) chilled water; 29.4 C (.072 L/s-kW) cooling water; 54.4/60C hot water; fouling factor. 000044 m²-hr-°C/W for absorber and condenser, .0000176 m²-hr-°C/W for evaporator; natural gas heating value 8899 kcal/m³ (LHV); No 2 oil heating value 9320 kcal/L Higher Heating Capacity is available.
 3. Specifications are subject to change.

16 DNH Absorption Chiller – 660 usRT

- Model : **16DNH066 (660 usRT)**
- Dimension(Length x Width x Height)
 - 6,142 x 2,866 x 3,102 mm
- Net Weight : 23,990 kg
- Features
 - Alternative-energy chiller/heater
 - Direct-fired, high-efficiency and double effect absorption cooling cycle
 - Superior part-load performance
 - Operation in the heating mode for additional savings
 - Ideal for new or retrofit applications
 - Combined use of absorption and electric-driven chillers
 - Employment of **SVEP**'s plate type heat exchanger for high efficiency

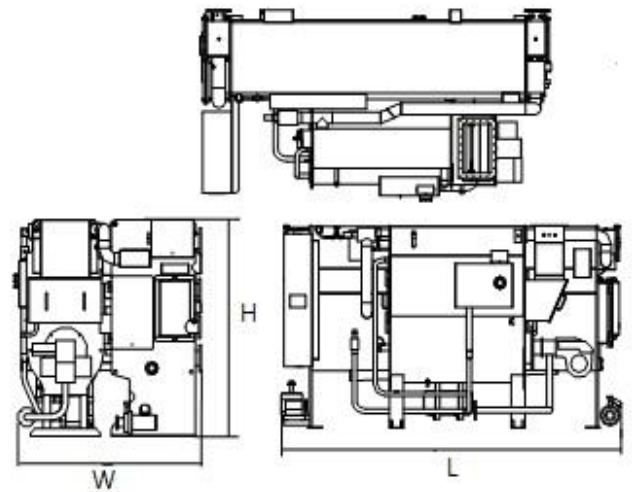

Specification

Cooling Capacity		kW	2,321
Heating Capacity		kW	1,648
Chilled Water	Flow Rate	l/sec	99.8
	Pressure Drop	kPa	63.6
Cooling Water	Flow Rate	l/sec	167.1
	Pressure Drop	kPa	99.8
Hot Water	Flow Rate	l/sec	81.2
	Pressure Drop	kPa	49.4
Fuel Consumption	Natural Gas	m ³ /hr.	185.4
	No. 2 Oil	l/hr.	177.0
Coefficient of Performance(COP)	Natural Gas	-	1.33
	No. 2 Oil	-	1.33
Rigging Weight	Absorber/Evaporator/ G2/ Condenser	kg	14,160
	G1 (Includes Burner)	kg	5,230
	LiBr Solution Charge	kg	3,700
	Refrigerant (Water) Charge	kg	900
	Total	kg	23,990
Operating Weight		kg	27,000
Chilled/Hot Water (Evap.)	Pipe Connection Size	in	8
	No. Passes	-	2
Cooling Water	Pipe Connection Size	in	12
	No. Passes	Absorber	2
		Condenser	1
Gas-Train Inlet	Standard Pipe Connection Size	in	1.5
Exhaust Gas Outlet	Nominal Flange Connection Size	mm	820 x 406

- Note)**
1. G1-High Temperature Generator, G2-Low Temperature Generator
 2. Ratings are based on ARI 560, latest edition, 12.2/6.7 C (.043 L/s-kW) chilled water; 29.4 C (.072 L/s-kW) cooling water; 54.4/60C hot water; fouling factor. 000044 m²-hr-°C/W for absorber and condenser, .0000176 m²-hr-°C/W for evaporator; natural gas heating value 8899 kcal/m³ (LHV); No 2 oil heating value 9320 kcal/L Higher Heating Capacity is available.
 3. Specifications are subject to change.



16 DN Absorption Chiller (COP 1.11)

Keep on building our PRIDE

ONLY through the TRUST



Have ALWAYS been right behind the MIRACLE

CLK Corporation

(Carrier Limited Korea)

8th~9th Floor, E.C.F.C. Building, 19-7, Nonhyun-dong, Gangnam-gu Seoul, Korea [135-010]

Telephone: +82-2-3441-2586, 8850, 2582 / Fax: +82-2-544-2583 / E-mail: OverseasSales@carrier.co.kr

16 DN Absorption Chiller – 100 usRT

- Model : **16DN010 (100 usRT)**
- Dimension(Length x Width x Height)
 - 2,966 x 1,797 x 2,082 mm
- Net Weight : 4,930 kg
- Features
 - Alternative-energy chiller/heater
 - Direct-fired, high-efficiency and double effect absorption cooling cycle
 - Superior part-load performance
 - Operation in the heating mode for additional savings
 - Ideal for new or retrofit applications
 - Combined use of absorption and electric-driven chillers

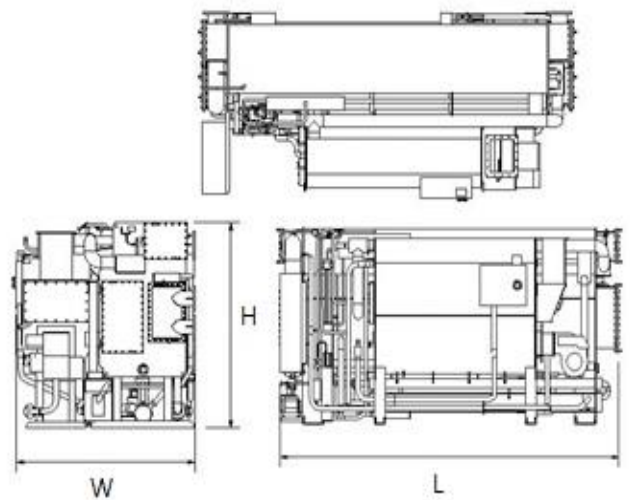

Specification

Cooling Capacity		kW	352
Heating Capacity		kW	294
Chilled Water	Flow Rate	ℓ/sec	15.1
	Pressure Drop	kPa	58.5
Cooling Water	Flow Rate	ℓ/sec	25.3
	Pressure Drop	kPa	42.0
Hot Water	Flow Rate	ℓ/sec	12.3
	Pressure Drop	kPa	34.8
Fuel Consumption	Natural Gas	m ³ /hr.	33.6
	No. 2 Oil	ℓ/hr.	32.1
Coefficient of Performance(COP)	Natural Gas	-	1.11
	No. 2 Oil	-	1.11
Rigging Weight	Absorber/Evaporator/ G2/ Condenser	kg	3,050
	G1 (Includes Burner)	kg	1,080
	LiBr Solution Charge	kg	650
	Refrigerant (Water) Charge	kg	150
	Total	kg	4,930
Operating Weight		kg	5,330
Chilled/Hot Water (Evap.)	Pipe Connection Size	in	4
	No. Passes	-	4
Cooling Water	Pipe Connection Size	in	5
	No. Passes	Absorber	3
		Condenser	1
Gas-Train Inlet	Standard Pipe Connection Size	in	1.5
Exhaust Gas Outlet	Nominal Flange Connection Size	mm	280 x 210

- Note)**
1. G1-High Temperature Generator, G2-Low Temperature Generator
 2. Ratings are based on ARI 560, latest edition, 12.2/6.7 C (.043 L/s-kW) chilled water; 29.4 C (.072 L/s-kW) cooling water; 54.4/60C hot water; fouling factor. 000044 m²-hr-°C/W for absorber and condenser, .0000176 m²-hr-°C/W for evaporator; natural gas heating value 8899 kcal/m³ (LHV); No 2 oil heating value 9320 kcal/L Higher Heating Capacity is available.
 3. Specifications are subject to change.

16 DN Absorption Chiller – 120 usRT

- Model : **16DN012 (120 usRT)**
- Dimension(Length x Width x Height)
 - 2,966 x 1,797 x 2,082 mm
- Net Weight : 5,250 kg
- Features
 - Alternative-energy chiller/heater
 - Direct-fired, high-efficiency and double effect absorption cooling cycle
 - Superior part-load performance
 - Operation in the heating mode for additional savings
 - Ideal for new or retrofit applications
 - Combined use of absorption and electric-driven chillers

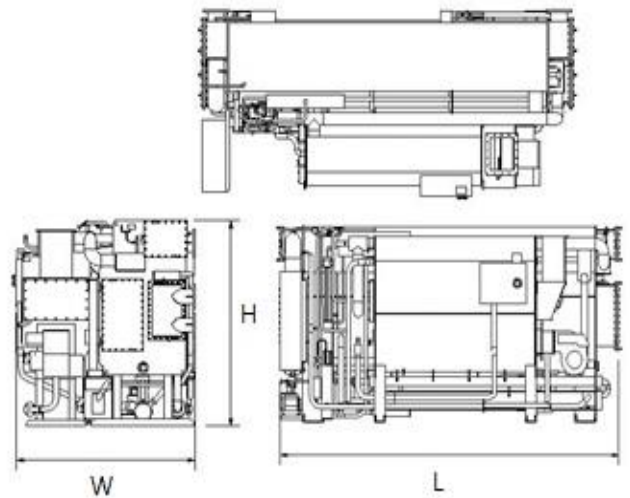

Specification

Cooling Capacity		kW	422
Heating Capacity		kW	352
Chilled Water	Flow Rate	ℓ/sec	18.1
	Pressure Drop	kPa	63.4
Cooling Water	Flow Rate	ℓ/sec	30.4
	Pressure Drop	kPa	46.1
Hot Water	Flow Rate	ℓ/sec	14.8
	Pressure Drop	kPa	38.4
Fuel Consumption	Natural Gas	m ³ /hr.	40.4
	No. 2 Oil	ℓ/hr.	38.6
Coefficient of Performance(COP)	Natural Gas	-	1.11
	No. 2 Oil	-	1.11
Rigging Weight	Absorber/Evaporator/ G2/ Condenser	kg	3,170
	G1 (Includes Burner)	kg	1,240
	LiBr Solution Charge	kg	700
	Refrigerant (Water) Charge	kg	140
	Total	kg	5,250
Operating Weight		kg	5,700
Chilled/Hot Water (Evap.)	Pipe Connection Size	in	4
	No. Passes	-	4
Cooling Water	Pipe Connection Size	in	5
	No. Passes	Absorber	3
		Condenser	1
Gas-Train Inlet	Standard Pipe Connection Size	in	1.5
Exhaust Gas Outlet	Nominal Flange Connection Size	mm	280 x 210

- Note)**
1. G1-High Temperature Generator, G2-Low Temperature Generator
 2. Ratings are based on ARI 560, latest edition, 12.2/6.7 C (.043 L/s-kW) chilled water; 29.4 C (.072 L/s-kW) cooling water; 54.4/60C hot water; fouling factor. 000044 m²-hr-°C/W for absorber and condenser, .0000176 m²-hr-°C/W for evaporator; natural gas heating value 8899 kcal/m³ (LHV); No 2 oil heating value 9320 kcal/L Higher Heating Capacity is available.
 3. Specifications are subject to change.

16 DN Absorption Chiller –150 usRT

- Model : **16DN015 (150 usRT)**
- Dimension(Length x Width x Height)
 - 3,638 x 1,830 x 2,056 mm
- Net Weight : 6,180 kg
- Features
 - Alternative-energy chiller/heater
 - Direct-fired, high-efficiency and double effect absorption cooling cycle
 - Superior part-load performance
 - Operation in the heating mode for additional savings
 - Ideal for new or retrofit applications
 - Combined use of absorption and electric-driven chillers

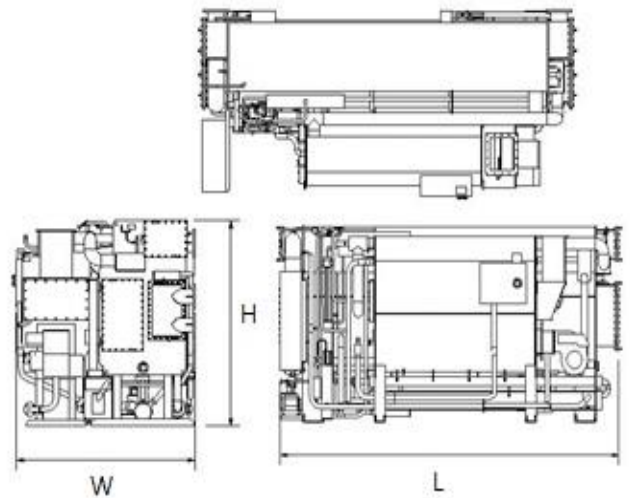

Specification

Cooling Capacity		kW	528
Heating Capacity		kW	440
Chilled Water	Flow Rate	ℓ/sec	22.7
	Pressure Drop	kPa	75.0
Cooling Water	Flow Rate	ℓ/sec	37.9
	Pressure Drop	kPa	63.6
Hot Water	Flow Rate	ℓ/sec	18.4
	Pressure Drop	kPa	44.1
Fuel Consumption	Natural Gas	m ³ /hr.	50.5
	No. 2 Oil	ℓ/hr.	48.2
Coefficient of Performance(COP)	Natural Gas	-	1.11
	No. 2 Oil	-	1.11
Rigging Weight	Absorber/Evaporator/ G2/ Condenser	kg	3,770
	G1 (Includes Burner)	kg	1,290
	LiBr Solution Charge	kg	880
	Refrigerant (Water) Charge	kg	240
	Total	kg	6,180
Operating Weight		kg	6,680
Chilled/Hot Water (Evap.)	Pipe Connection Size	in	4
	No. Passes	-	3
Cooling Water	Pipe Connection Size	in	5
	No. Passes	Absorber	2
		Condenser	1
Gas-Train Inlet	Standard Pipe Connection Size	in	1.5
Exhaust Gas Outlet	Nominal Flange Connection Size	mm	280 x 210

- Note)**
1. G1-High Temperature Generator, G2-Low Temperature Generator
 2. Ratings are based on ARI 560, latest edition, 12.2/6.7 C (.043 L/s-kW) chilled water; 29.4 C (.072 L/s-kW) cooling water; 54.4/60C hot water; fouling factor. 000044 m²-hr-°C/W for absorber and condenser, .0000176 m²-hr-°C/W for evaporator; natural gas heating value 8899 kcal/m³ (LHV); No 2 oil heating value 9320 kcal/L Higher Heating Capacity is available.
 3. Specifications are subject to change.

16 DN Absorption Chiller – 180 usRT

- Model : **16DN018 (180 usRT)**
- Dimension(Length x Width x Height)
 - 3,638 x 1,830 x 2,056 mm
- Net Weight : 6,555 kg
- Features
 - Alternative-energy chiller/heater
 - Direct-fired, high-efficiency and double effect absorption cooling cycle
 - Superior part-load performance
 - Operation in the heating mode for additional savings
 - Ideal for new or retrofit applications
 - Combined use of absorption and electric-driven chillers

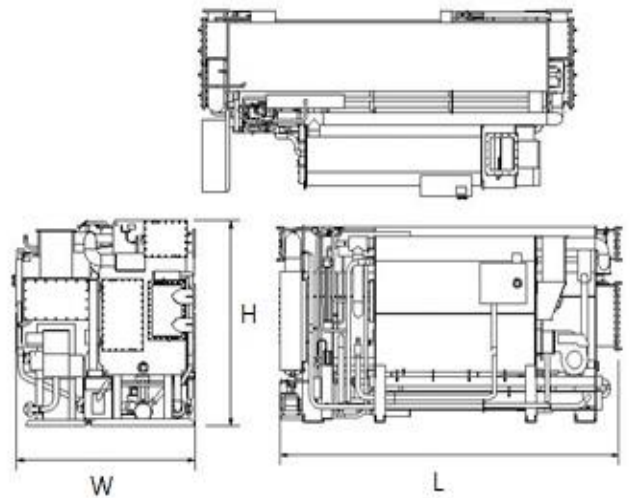

Specification

Cooling Capacity		kW	633
Heating Capacity		kW	528
Chilled Water	Flow Rate	ℓ/sec	27.3
	Pressure Drop	kPa	81.2
Cooling Water	Flow Rate	ℓ/sec	45.4
	Pressure Drop	kPa	72.9
Hot Water	Flow Rate	ℓ/sec	22.1
	Pressure Drop	kPa	48.6
Fuel Consumption	Natural Gas	m ³ /hr.	60.6
	No. 2 Oil	ℓ/hr.	57.8
Coefficient of Performance(COP)	Natural Gas	-	1.11
	No. 2 Oil	-	1.11
Rigging Weight	Absorber/Evaporator/ G2/ Condenser	kg	4,010
	G1 (Includes Burner)	kg	1,340
	LiBr Solution Charge	kg	970
	Refrigerant (Water) Charge	kg	235
	Total	kg	6,555
Operating Weight		kg	7,120
Chilled/Hot Water (Evap.)	Pipe Connection Size	in	4
	No. Passes	-	3
Cooling Water	Pipe Connection Size	in	5
	No. Passes	Absorber	2
		Condenser	1
Gas-Train Inlet	Standard Pipe Connection Size	in	1.5
Exhaust Gas Outlet	Nominal Flange Connection Size	mm	280 x 210

- Note)**
1. G1-High Temperature Generator, G2-Low Temperature Generator
 2. Ratings are based on ARI 560, latest edition, 12.2/6.7 C (.043 L/s-kW) chilled water; 29.4 C (.072 L/s-kW) cooling water; 54.4/60C hot water; fouling factor. 000044 m²-hr-°C/W for absorber and condenser, .0000176 m²-hr-°C/W for evaporator; natural gas heating value 8899 kcal/m³ (LHV); No 2 oil heating value 9320 kcal/L Higher Heating Capacity is available.
 3. Specifications are subject to change.

16 DN Absorption Chiller – 210 usRT

- Model : **16DN021 (210 usRT)**
- Dimension(Length x Width x Height)
 - 3,679 x 2,034 x 2,313 mm
- Net Weight : 7,550 kg
- Features
 - Alternative-energy chiller/heater
 - Direct-fired, high-efficiency and double effect absorption cooling cycle
 - Superior part-load performance
 - Operation in the heating mode for additional savings
 - Ideal for new or retrofit applications
 - Combined use of absorption and electric-driven chillers

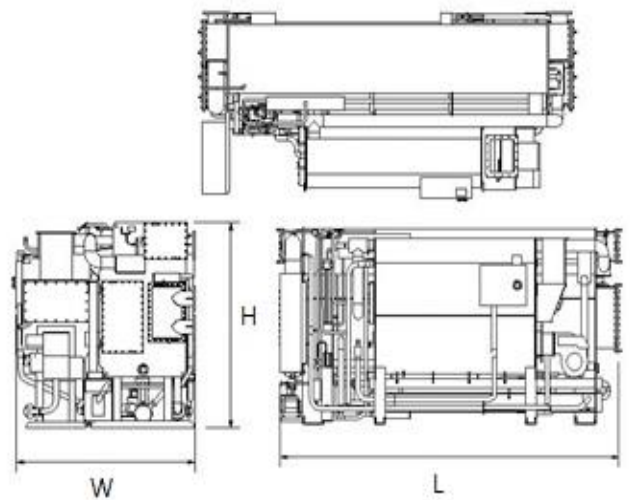

Specification

Cooling Capacity		kW	739
Heating Capacity		kW	616
Chilled Water	Flow Rate	ℓ/sec	31.8
	Pressure Drop	kPa	77.9
Cooling Water	Flow Rate	ℓ/sec	53.0
	Pressure Drop	kPa	51.3
Hot Water	Flow Rate	ℓ/sec	25.8
	Pressure Drop	kPa	45.6
Fuel Consumption	Natural Gas	m ³ /hr.	70.7
	No. 2 Oil	ℓ/hr.	67.5
Coefficient of Performance(COP)	Natural Gas	-	1.11
	No. 2 Oil	-	1.11
Rigging Weight	Absorber/Evaporator/ G2/ Condenser	kg	4,620
	G1 (Includes Burner)	kg	1,450
	LiBr Solution Charge	kg	1,170
	Refrigerant (Water) Charge	kg	310
	Total	kg	7,550
Operating Weight		kg	8,270
Chilled/Hot Water (Evap.)	Pipe Connection Size	in	5
	No. Passes	-	3
Cooling Water	Pipe Connection Size	in	6
	No. Passes	Absorber	2
		Condenser	1
Gas-Train Inlet	Standard Pipe Connection Size	in	1.5
Exhaust Gas Outlet	Nominal Flange Connection Size	mm	310 x 310

- Note)**
1. G1-High Temperature Generator, G2-Low Temperature Generator
 2. Ratings are based on ARI 560, latest edition, 12.2/6.7 C (.043 L/s-kW) chilled water; 29.4 C (.072 L/s-kW) cooling water; 54.4/60C hot water; fouling factor. 000044 m²-hr-°C/W for absorber and condenser, .0000176 m²-hr-°C/W for evaporator; natural gas heating value 8899 kcal/m³ (LHV); No 2 oil heating value 9320 kcal/L Higher Heating Capacity is available.
 3. Specifications are subject to change.

16 DN Absorption Chiller – 240 usRT

- Model : **16DN024 (240 usRT)**
- Dimension(Length x Width x Height)
 - 3,679 x 2,034 x 2,313 mm
- Net Weight : 8,130 kg
- Features
 - Alternative-energy chiller/heater
 - Direct-fired, high-efficiency and double effect absorption cooling cycle
 - Superior part-load performance
 - Operation in the heating mode for additional savings
 - Ideal for new or retrofit applications
 - Combined use of absorption and electric-driven chillers

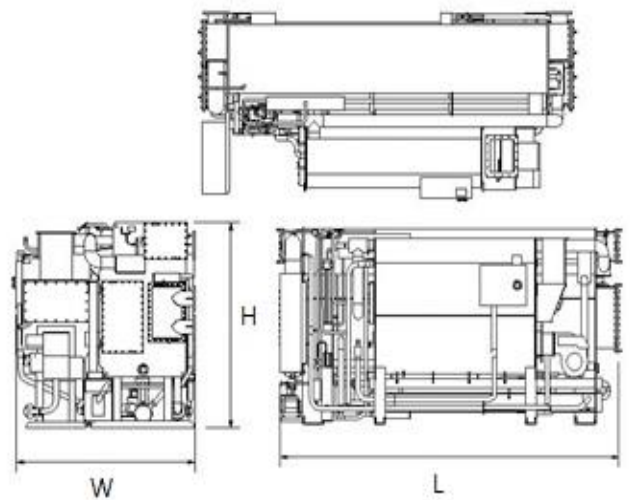

Specification

Cooling Capacity		kW	844
Heating Capacity		kW	704
Chilled Water	Flow Rate	ℓ/sec	36.3
	Pressure Drop	kPa	79.7
Cooling Water	Flow Rate	ℓ/sec	60.6
	Pressure Drop	kPa	57.0
Hot Water	Flow Rate	ℓ/sec	29.5
	Pressure Drop	kPa	47.3
Fuel Consumption	Natural Gas	m ³ /hr.	80.7
	No. 2 Oil	ℓ/hr.	77.1
Coefficient of Performance(COP)	Natural Gas	-	1.11
	No. 2 Oil	-	1.11
Rigging Weight	Absorber/Evaporator/ G2/ Condenser	kg	4,930
	G1 (Includes Burner)	kg	1,660
	LiBr Solution Charge	kg	1,240
	Refrigerant (Water) Charge	kg	300
	Total	kg	8,130
Operating Weight		kg	8,930
Chilled/Hot Water (Evap.)	Pipe Connection Size	in	5
	No. Passes	-	3
Cooling Water	Pipe Connection Size	in	6
	No. Passes	Absorber	2
		Condenser	1
Gas-Train Inlet	Standard Pipe Connection Size	in	1.5
Exhaust Gas Outlet	Nominal Flange Connection Size	mm	310 x 310

- Note)**
1. G1-High Temperature Generator, G2-Low Temperature Generator
 2. Ratings are based on ARI 560, latest edition, 12.2/6.7 C (.043 L/s-kW) chilled water; 29.4 C (.072 L/s-kW) cooling water; 54.4/60C hot water; fouling factor. 000044 m²-hr-°C/W for absorber and condenser, .0000176 m²-hr-°C/W for evaporator; natural gas heating value 8899 kcal/m³ (LHV); No 2 oil heating value 9320 kcal/L Higher Heating Capacity is available.
 3. Specifications are subject to change.

16 DN Absorption Chiller – 280 usRT

- Model : **16DN028 (280 usRT)**
- Dimension(Length x Width x Height)
 - 4,780 x 2,072 x 2,381 mm
- Net Weight : 9,860 kg
- Features
 - Alternative-energy chiller/heater
 - Direct-fired, high-efficiency and double effect absorption cooling cycle
 - Superior part-load performance
 - Operation in the heating mode for additional savings
 - Ideal for new or retrofit applications
 - Combined use of absorption and electric-driven chillers

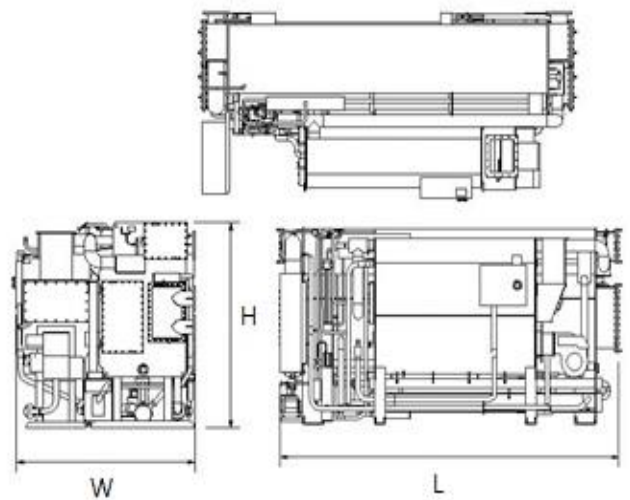

Specification

Cooling Capacity		kW	985
Heating Capacity		kW	821
Chilled Water	Flow Rate	ℓ/sec	42.4
	Pressure Drop	kPa	52.4
Cooling Water	Flow Rate	ℓ/sec	70.7
	Pressure Drop	kPa	77.8
Hot Water	Flow Rate	ℓ/sec	34.4
	Pressure Drop	kPa	30.6
Fuel Consumption	Natural Gas	m ³ /hr.	94.2
	No. 2 Oil	ℓ/hr.	90.0
Coefficient of Performance(COP)	Natural Gas	-	1.11
	No. 2 Oil	-	1.11
Rigging Weight	Absorber/Evaporator/ G2/ Condenser	kg	5,870
	G1 (Includes Burner)	kg	1,820
	LiBr Solution Charge	kg	1,730
	Refrigerant (Water) Charge	kg	440
	Total	kg	9,860
Operating Weight		kg	10,810
Chilled/Hot Water (Evap.)	Pipe Connection Size	in	6
	No. Passes	-	2
Cooling Water	Pipe Connection Size	in	8
	No. Passes	Absorber	2
		Condenser	1
Gas-Train Inlet	Standard Pipe Connection Size	in	1.5
Exhaust Gas Outlet	Nominal Flange Connection Size	mm	310 x 310

- Note)**
1. G1-High Temperature Generator, G2-Low Temperature Generator
 2. Ratings are based on ARI 560, latest edition, 12.2/6.7 C (.043 L/s-kW) chilled water; 29.4 C (.072 L/s-kW) cooling water; 54.4/60C hot water; fouling factor. 000044 m²-hr-°C/W for absorber and condenser, .0000176 m²-hr-°C/W for evaporator; natural gas heating value 8899 kcal/m³ (LHV); No 2 oil heating value 9320 kcal/L Higher Heating Capacity is available.
 3. Specifications are subject to change.

16 DN Absorption Chiller – 330 usRT

- Model : **16DN033 (330 usRT)**
- Dimension(Length x Width x Height)
 - 4,780 x 2,072 x 2,381 mm
- Net Weight : 10,410 kg
- Features
 - Alternative-energy chiller/heater
 - Direct-fired, high-efficiency and double effect absorption cooling cycle
 - Superior part-load performance
 - Operation in the heating mode for additional savings
 - Ideal for new or retrofit applications
 - Combined use of absorption and electric-driven chillers

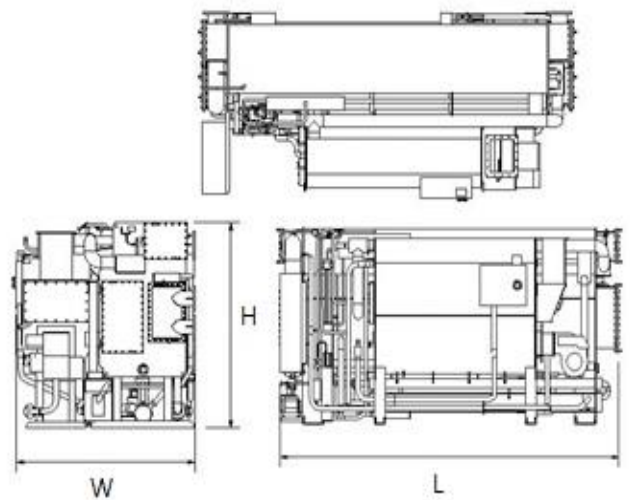

Specification

Cooling Capacity		kW	1,161
Heating Capacity		kW	968
Chilled Water	Flow Rate	ℓ/sec	50.0
	Pressure Drop	kPa	54.9
Cooling Water	Flow Rate	ℓ/sec	83.3
	Pressure Drop	kPa	83.0
Hot Water	Flow Rate	ℓ/sec	40.6
	Pressure Drop	kPa	32.6
Fuel Consumption	Natural Gas	m ³ /hr.	111.0
	No. 2 Oil	ℓ/hr.	106.0
Coefficient of Performance(COP)	Natural Gas	-	1.11
	No. 2 Oil	-	1.11
Rigging Weight	Absorber/Evaporator/ G2/ Condenser	kg	6,100
	G1 (Includes Burner)	kg	2,060
	LiBr Solution Charge	kg	1,820
	Refrigerant (Water) Charge	kg	430
	Total	kg	10,410
Operating Weight		kg	11,470
Chilled/Hot Water (Evap.)	Pipe Connection Size	in	6
	No. Passes	-	2
Cooling Water	Pipe Connection Size	in	8
	No. Passes	Absorber	2
		Condenser	1
Gas-Train Inlet	Standard Pipe Connection Size	in	1.5
Exhaust Gas Outlet	Nominal Flange Connection Size	mm	310 x 310

- Note)**
1. G1-High Temperature Generator, G2-Low Temperature Generator
 2. Ratings are based on ARI 560, latest edition, 12.2/6.7 C (.043 L/s-kW) chilled water; 29.4 C (.072 L/s-kW) cooling water; 54.4/60C hot water; fouling factor. 000044 m²-hr-°C/W for absorber and condenser, .0000176 m²-hr-°C/W for evaporator; natural gas heating value 8899 kcal/m³ (LHV); No 2 oil heating value 9320 kcal/L Higher Heating Capacity is available.
 3. Specifications are subject to change.

16 DN Absorption Chiller – 360 usRT

- Model : **16DN036 (360 usRT)**
- Dimension(Length x Width x Height)
 - 4,780 x 2,299 x 2,630 mm
- Net Weight : 11,230 kg
- Features
 - Alternative-energy chiller/heater
 - Direct-fired, high-efficiency and double effect absorption cooling cycle
 - Superior part-load performance
 - Operation in the heating mode for additional savings
 - Ideal for new or retrofit applications
 - Combined use of absorption and electric-driven chillers

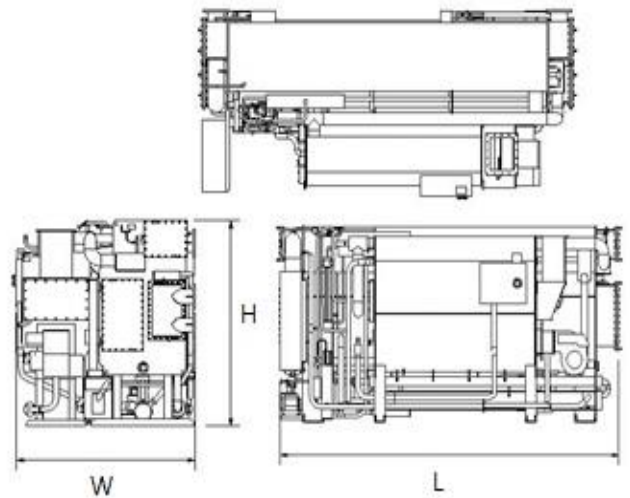

Specification

Cooling Capacity		kW	1,266
Heating Capacity		kW	1,055
Chilled Water	Flow Rate	ℓ/sec	54.5
	Pressure Drop	kPa	54.2
Cooling Water	Flow Rate	ℓ/sec	90.8
	Pressure Drop	kPa	90.9
Hot Water	Flow Rate	ℓ/sec	44.3
	Pressure Drop	kPa	32.6
Fuel Consumption	Natural Gas	m ³ /hr.	121.1
	No. 2 Oil	ℓ/hr.	115.7
Coefficient of Performance(COP)	Natural Gas	-	1.11
	No. 2 Oil	-	1.11
Rigging Weight	Absorber/Evaporator/ G2/ Condenser	kg	6,520
	G1 (Includes Burner)	kg	2,370
	LiBr Solution Charge	kg	1,830
	Refrigerant (Water) Charge	kg	510
	Total	kg	11,230
Operating Weight		kg	12,510
Chilled/Hot Water (Evap.)	Pipe Connection Size	in	6
	No. Passes	-	2
Cooling Water	Pipe Connection Size	in	8
	No. Passes	Absorber	2
		Condenser	1
Gas-Train Inlet	Standard Pipe Connection Size	in	1.5
Exhaust Gas Outlet	Nominal Flange Connection Size	mm	360 x 310

- Note)**
1. G1-High Temperature Generator, G2-Low Temperature Generator
 2. Ratings are based on ARI 560, latest edition, 12.2/6.7 C (.043 L/s-kW) chilled water; 29.4 C (.072 L/s-kW) cooling water; 54.4/60C hot water; fouling factor. 000044 m²-hr-°C/W for absorber and condenser, .0000176 m²-hr-°C/W for evaporator; natural gas heating value 8899 kcal/m³ (LHV); No 2 oil heating value 9320 kcal/L Higher Heating Capacity is available.
 3. Specifications are subject to change.

16 DN Absorption Chiller – 400 usRT

- Model : **16DN040 (400 usRT)**
- Dimension(Length x Width x Height)
 - 4,780 x 2,299 x 2,630 mm
- Net Weight : 12,150 kg
- Features
 - Alternative-energy chiller/heater
 - Direct-fired, high-efficiency and double effect absorption cooling cycle
 - Superior part-load performance
 - Operation in the heating mode for additional savings
 - Ideal for new or retrofit applications
 - Combined use of absorption and electric-driven chillers

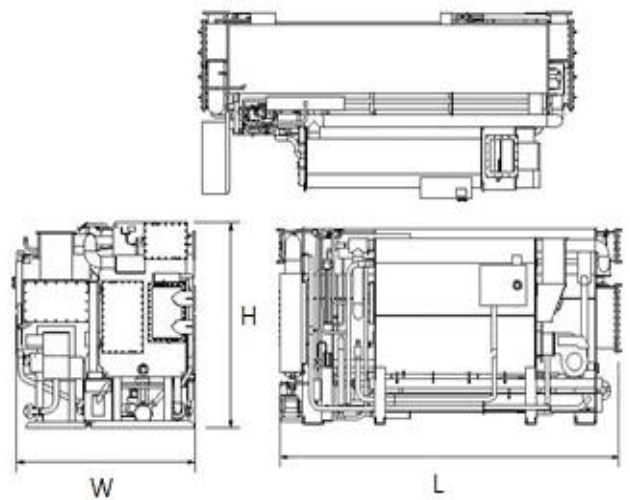

Specification

Cooling Capacity		kW	1,407
Heating Capacity		kW	1,173
Chilled Water	Flow Rate	ℓ/sec	60.6
	Pressure Drop	kPa	55.7
Cooling Water	Flow Rate	ℓ/sec	100.9
	Pressure Drop	kPa	95.2
Hot Water	Flow Rate	ℓ/sec	49.2
	Pressure Drop	kPa	34.1
Fuel Consumption	Natural Gas	m ³ /hr.	134.6
	No. 2 Oil	ℓ/hr.	128.5
Coefficient of Performance(COP)	Natural Gas	-	1.11
	No. 2 Oil	-	1.11
Rigging Weight	Absorber/Evaporator/ G2/ Condenser	kg	7,020
	G1 (Includes Burner)	kg	2,690
	LiBr Solution Charge	kg	1,940
	Refrigerant (Water) Charge	kg	500
	Total	kg	12,150
Operating Weight		kg	13,500
Chilled/Hot Water (Evap.)	Pipe Connection Size	in	6
	No. Passes	-	2
Cooling Water	Pipe Connection Size	in	8
	No. Passes	Absorber	2
		Condenser	1
Gas-Train Inlet	Standard Pipe Connection Size	in	1.5
Exhaust Gas Outlet	Nominal Flange Connection Size	mm	360 x 310

- Note)**
1. G1-High Temperature Generator, G2-Low Temperature Generator
 2. Ratings are based on ARI 560, latest edition, 12.2/6.7 C (.043 L/s-kW) chilled water; 29.4 C (.072 L/s-kW) cooling water; 54.4/60C hot water; fouling factor. 000044 m²-hr-°C/W for absorber and condenser, .0000176 m²-hr-°C/W for evaporator; natural gas heating value 8899 kcal/m³ (LHV); No 2 oil heating value 9320 kcal/L Higher Heating Capacity is available.
 3. Specifications are subject to change.

16 DN Absorption Chiller – 450 usRT

- Model : **16DN045 (450 usRT)**
- Dimension(Length x Width x Height)
 - 4,867 x 2,493 2,820 mm
- Net Weight : 15,010 kg
- Features
 - Alternative-energy chiller/heater
 - Direct-fired, high-efficiency and double effect absorption cooling cycle
 - Superior part-load performance
 - Operation in the heating mode for additional savings
 - Ideal for new or retrofit applications
 - Combined use of absorption and electric-driven chillers

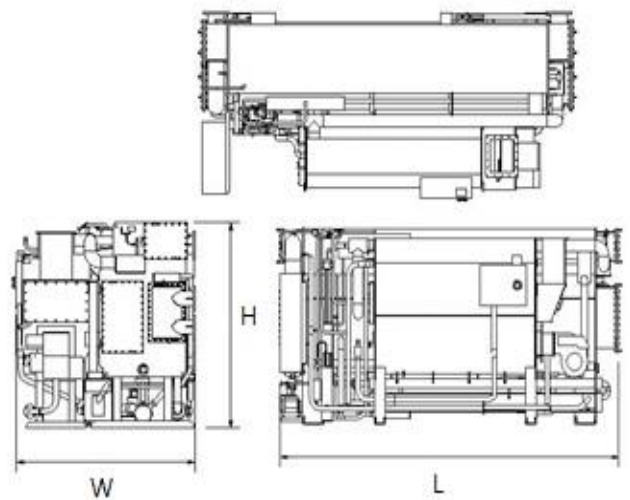

Specification

Cooling Capacity		kW	1,583
Heating Capacity		kW	1,319
Chilled Water	Flow Rate	ℓ/sec	68.1
	Pressure Drop	kPa	54.1
Cooling Water	Flow Rate	ℓ/sec	113.6
	Pressure Drop	kPa	83.9
Hot Water	Flow Rate	ℓ/sec	55.3
	Pressure Drop	kPa	31.1
Fuel Consumption	Natural Gas	m ³ /hr.	151.4
	No. 2 Oil	ℓ/hr.	144.6
Coefficient of Performance(COP)	Natural Gas	-	1.11
	No. 2 Oil	-	1.11
Rigging Weight	Absorber/Evaporator/ G2/ Condenser	kg	8,680
	G1 (Includes Burner)	kg	3,240
	LiBr Solution Charge	kg	2,570
	Refrigerant (Water) Charge	kg	520
	Total	kg	15,010
Operating Weight		kg	16,550
Chilled/Hot Water (Evap.)	Pipe Connection Size	in	8
	No. Passes	-	2
Cooling Water	Pipe Connection Size	in	10
	No. Passes	Absorber	2
		Condenser	1
Gas-Train Inlet	Standard Pipe Connection Size	in	1.5
Exhaust Gas Outlet	Nominal Flange Connection Size	mm	410 x 310

- Note)**
1. G1-High Temperature Generator, G2-Low Temperature Generator
 2. Ratings are based on ARI 560, latest edition, 12.2/6.7 C (.043 L/s-kW) chilled water; 29.4 C (.072 L/s-kW) cooling water; 54.4/60C hot water; fouling factor. 000044 m²-hr-°C/W for absorber and condenser, .0000176 m²-hr-°C/W for evaporator; natural gas heating value 8899 kcal/m³ (LHV); No 2 oil heating value 9320 kcal/L Higher Heating Capacity is available.
 3. Specifications are subject to change.

16 DN Absorption Chiller – 500 usRT

- Model : **16DN050 (500 usRT)**
- Dimension(Length x Width x Height)
 - 4,867 x 2,493 2,820 mm
- Net Weight : 15,660 kg
- Features
 - Alternative-energy chiller/heater
 - Direct-fired, high-efficiency and double effect absorption cooling cycle
 - Superior part-load performance
 - Operation in the heating mode for additional savings
 - Ideal for new or retrofit applications
 - Combined use of absorption and electric-driven chillers

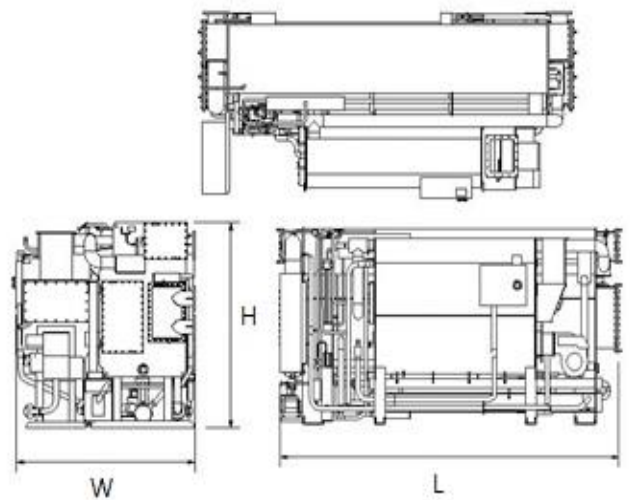

Specification

Cooling Capacity		kW	1,758
Heating Capacity		kW	1,466
Chilled Water	Flow Rate	ℓ/sec	75.7
	Pressure Drop	kPa	54.5
Cooling Water	Flow Rate	ℓ/sec	126.2
	Pressure Drop	kPa	86.8
Hot Water	Flow Rate	ℓ/sec	61.5
	Pressure Drop	kPa	31.6
Fuel Consumption	Natural Gas	m ³ /hr.	168.2
	No. 2 Oil	ℓ/hr.	160.6
Coefficient of Performance(COP)	Natural Gas	-	1.11
	No. 2 Oil	-	1.11
Rigging Weight	Absorber/Evaporator/ G2/ Condenser	kg	8,850
	G1 (Includes Burner)	kg	3,600
	LiBr Solution Charge	kg	2,700
	Refrigerant (Water) Charge	kg	510
	Total	kg	15,660
Operating Weight		kg	17,320
Chilled/Hot Water (Evap.)	Pipe Connection Size	in	8
	No. Passes	-	2
Cooling Water	Pipe Connection Size	in	10
	No. Passes	Absorber	2
		Condenser	1
Gas-Train Inlet	Standard Pipe Connection Size	in	1.5
Exhaust Gas Outlet	Nominal Flange Connection Size	mm	410 x 310

- Note)**
1. G1-High Temperature Generator, G2-Low Temperature Generator
 2. Ratings are based on ARI 560, latest edition, 12.2/6.7 C (.043 L/s-kW) chilled water; 29.4 C (.072 L/s-kW) cooling water; 54.4/60C hot water; fouling factor. 000044 m²-hr-°C/W for absorber and condenser, .0000176 m²-hr-°C/W for evaporator; natural gas heating value 8899 kcal/m³ (LHV); No 2 oil heating value 9320 kcal/L Higher Heating Capacity is available.
 3. Specifications are subject to change.

16 DN Absorption Chiller – 560 usRT

- Model : **16DN056 (560 usRT)**
- Dimension(Length x Width x Height)
 - 5,088 x 2,905 x 3,102 mm
- Net Weight : 19,590 kg
- Features
 - Alternative-energy chiller/heater
 - Direct-fired, high-efficiency and double effect absorption cooling cycle
 - Superior part-load performance
 - Operation in the heating mode for additional savings
 - Ideal for new or retrofit applications
 - Combined use of absorption and electric-driven chillers

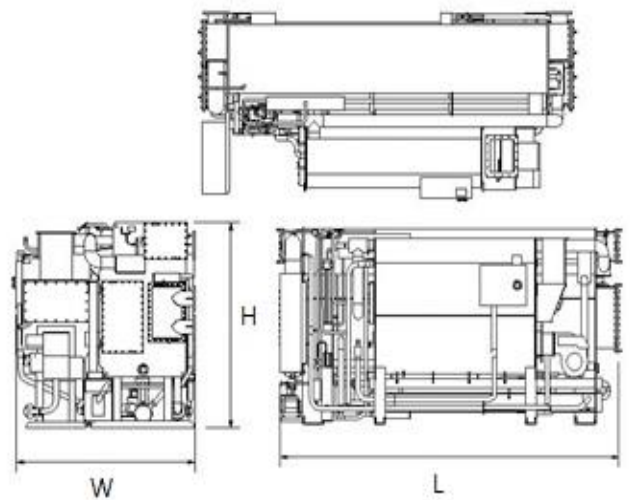

Specification

Cooling Capacity		kW	1,969
Heating Capacity		kW	1,644
Chilled Water	Flow Rate	ℓ/sec	84.7
	Pressure Drop	kPa	36.9
Cooling Water	Flow Rate	ℓ/sec	141.8
	Pressure Drop	kPa	56.6
Hot Water	Flow Rate	ℓ/sec	68.9
	Pressure Drop	kPa	29.0
Fuel Consumption	Natural Gas	m ³ /hr.	188.4
	No. 2 Oil	ℓ/hr.	179.9
Coefficient of Performance(COP)	Natural Gas	-	1.11
	No. 2 Oil	-	1.11
Rigging Weight	Absorber/Evaporator/ G2/ Condenser	kg	11,370
	G1 (Includes Burner)	kg	4,670
	LiBr Solution Charge	kg	3,100
	Refrigerant (Water) Charge	kg	450
	Total	kg	19,590
Operating Weight		kg	22,320
Chilled/Hot Water (Evap.)	Pipe Connection Size	in	8
	No. Passes	-	2
Cooling Water	Pipe Connection Size	in	12
	No. Passes	Absorber	2
		Condenser	1
Gas-Train Inlet	Standard Pipe Connection Size	in	2
Exhaust Gas Outlet	Nominal Flange Connection Size	mm	500 x 350

- Note)**
1. G1-High Temperature Generator, G2-Low Temperature Generator
 2. Ratings are based on ARI 560, latest edition, 12.2/6.7 C (.043 L/s-kW) chilled water; 29.4 C (.072 L/s-kW) cooling water; 54.4/60C hot water; fouling factor. 000044 m²-hr-°C/W for absorber and condenser, .0000176 m²-hr-°C/W for evaporator; natural gas heating value 8899 kcal/m³ (LHV); No 2 oil heating value 9320 kcal/L Higher Heating Capacity is available.
 3. Specifications are subject to change.

16 DN Absorption Chiller – 600 usRT

- Model : **16DN060 (600 usRT)**
- Dimension(Length x Width x Height)
 - 5,640 x 2,905 x 3,102 mm
- Net Weight : 21,080 kg
- Features
 - Alternative-energy chiller/heater
 - Direct-fired, high-efficiency and double effect absorption cooling cycle
 - Superior part-load performance
 - Operation in the heating mode for additional savings
 - Ideal for new or retrofit applications
 - Combined use of absorption and electric-driven chillers

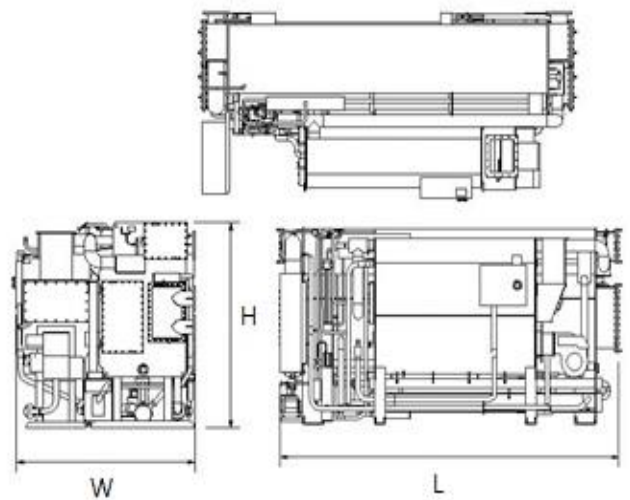

Specification

Cooling Capacity		kW	2,110
Heating Capacity		kW	1,762
Chilled Water	Flow Rate	ℓ/sec	90.7
	Pressure Drop	kPa	48.8
Cooling Water	Flow Rate	ℓ/sec	151.9
	Pressure Drop	kPa	76.3
Hot Water	Flow Rate	ℓ/sec	73.8
	Pressure Drop	kPa	38.0
Fuel Consumption	Natural Gas	m ³ /hr.	201.9
	No. 2 Oil	ℓ/hr.	192.8
Coefficient of Performance(COP)	Natural Gas	-	1.11
	No. 2 Oil	-	1.11
Rigging Weight	Absorber/Evaporator/ G2/ Condenser	kg	12,520
	G1 (Includes Burner)	kg	4,670
	LiBr Solution Charge	kg	3,440
	Refrigerant (Water) Charge	kg	450
	Total	kg	21,080
Operating Weight		kg	23,800
Chilled/Hot Water (Evap.)	Pipe Connection Size	in	8
	No. Passes	-	2
Cooling Water	Pipe Connection Size	in	12
	No. Passes	Absorber	2
		Condenser	1
Gas-Train Inlet	Standard Pipe Connection Size	in	2
Exhaust Gas Outlet	Nominal Flange Connection Size	mm	500 x 350

- Note)**
1. G1-High Temperature Generator, G2-Low Temperature Generator
 2. Ratings are based on ARI 560, latest edition, 12.2/6.7 C (.043 L/s-kW) chilled water; 29.4 C (.072 L/s-kW) cooling water; 54.4/60C hot water; fouling factor. 000044 m²-hr-°C/W for absorber and condenser, .0000176 m²-hr-°C/W for evaporator; natural gas heating value 8899 kcal/m³ (LHV); No 2 oil heating value 9320 kcal/L Higher Heating Capacity is available.
 3. Specifications are subject to change.

16 DN Absorption Chiller – 630 usRT

- Model : **16DN063 (630 usRT)**
- Dimension(Length x Width x Height)
 - 5,640 x 2,905 x 3,102 mm
- Net Weight : 21,250 kg
- Features
 - Alternative-energy chiller/heater
 - Direct-fired, high-efficiency and double effect absorption cooling cycle
 - Superior part-load performance
 - Operation in the heating mode for additional savings
 - Ideal for new or retrofit applications
 - Combined use of absorption and electric-driven chillers

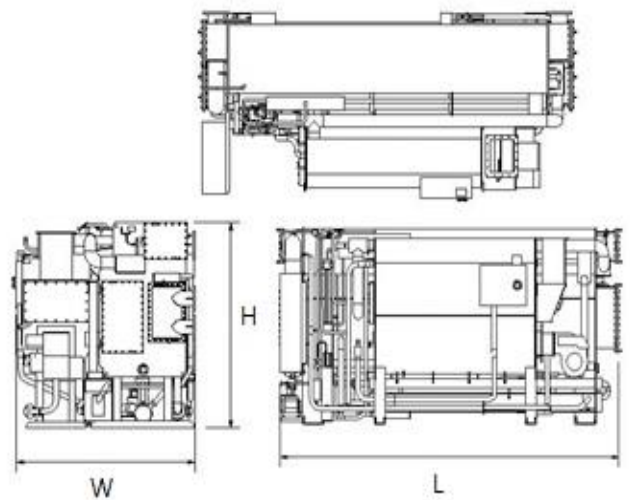

Specification

Cooling Capacity		kW	2,216
Heating Capacity		kW	1,850
Chilled Water	Flow Rate	ℓ/sec	95.3
	Pressure Drop	kPa	49.9
Cooling Water	Flow Rate	ℓ/sec	159.5
	Pressure Drop	kPa	77.1
Hot Water	Flow Rate	ℓ/sec	77.5
	Pressure Drop	kPa	39.1
Fuel Consumption	Natural Gas	m ³ /hr.	212.0
	No. 2 Oil	ℓ/hr.	202.4
Coefficient of Performance(COP)	Natural Gas	-	1.11
	No. 2 Oil	-	1.11
Rigging Weight	Absorber/Evaporator/ G2/ Condenser	kg	12,690
	G1 (Includes Burner)	kg	4,670
	LiBr Solution Charge	kg	3,440
	Refrigerant (Water) Charge	kg	450
	Total	kg	21,250
Operating Weight		kg	24,080
Chilled/Hot Water (Evap.)	Pipe Connection Size	in	8
	No. Passes	-	2
Cooling Water	Pipe Connection Size	in	12
	No. Passes	Absorber	2
		Condenser	1
Gas-Train Inlet	Standard Pipe Connection Size	in	2
Exhaust Gas Outlet	Nominal Flange Connection Size	mm	500 x 350

- Note)**
1. G1-High Temperature Generator, G2-Low Temperature Generator
 2. Ratings are based on ARI 560, latest edition, 12.2/6.7 C (.043 L/s-kW) chilled water; 29.4 C (.072 L/s-kW) cooling water; 54.4/60C hot water; fouling factor. 000044 m²-hr-°C/W for absorber and condenser, .0000176 m²-hr-°C/W for evaporator; natural gas heating value 8899 kcal/m³ (LHV); No 2 oil heating value 9320 kcal/L Higher Heating Capacity is available.
 3. Specifications are subject to change.

16 DN Absorption Chiller – 660 usRT

- Model : **16DN066 (660 usRT)**
- Dimension(Length x Width x Height)
 - 6,142 x 2,905 x 3,102 mm
- Net Weight : 22,970 kg
- Features
 - Alternative-energy chiller/heater
 - Direct-fired, high-efficiency and double effect absorption cooling cycle
 - Superior part-load performance
 - Operation in the heating mode for additional savings
 - Ideal for new or retrofit applications
 - Combined use of absorption and electric-driven chillers

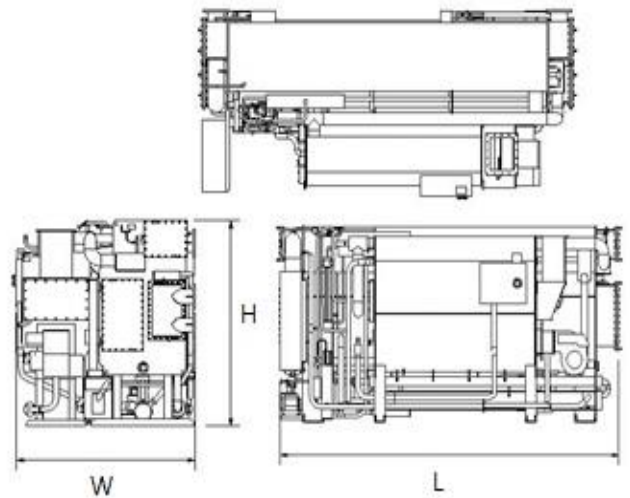

Specification

Cooling Capacity		kW	2,321
Heating Capacity		kW	1,938
Chilled Water	Flow Rate	ℓ/sec	99.8
	Pressure Drop	kPa	63.6
Cooling Water	Flow Rate	ℓ/sec	167.1
	Pressure Drop	kPa	99.8
Hot Water	Flow Rate	ℓ/sec	81.2
	Pressure Drop	kPa	49.4
Fuel Consumption	Natural Gas	m ³ /hr.	222.1
	No. 2 Oil	ℓ/hr.	212.0
Coefficient of Performance(COP)	Natural Gas	-	1.11
	No. 2 Oil	-	1.11
Rigging Weight	Absorber/Evaporator/ G2/ Condenser	kg	13,740
	G1 (Includes Burner)	kg	4,910
	LiBr Solution Charge	kg	3,820
	Refrigerant (Water) Charge	kg	500
	Total	kg	22,970
Operating Weight		kg	25,800
Chilled/Hot Water (Evap.)	Pipe Connection Size	in	8
	No. Passes	-	2
Cooling Water	Pipe Connection Size	in	12
	No. Passes	Absorber	2
		Condenser	1
Gas-Train Inlet	Standard Pipe Connection Size	in	2
Exhaust Gas Outlet	Nominal Flange Connection Size	mm	500 x 350

- Note)**
1. G1-High Temperature Generator, G2-Low Temperature Generator
 2. Ratings are based on ARI 560, latest edition, 12.2/6.7 C (.043 L/s-kW) chilled water; 29.4 C (.072 L/s-kW) cooling water; 54.4/60C hot water; fouling factor. 000044 m²-hr-°C/W for absorber and condenser, .0000176 m²-hr-°C/W for evaporator; natural gas heating value 8899 kcal/m³ (LHV); No 2 oil heating value 9320 kcal/L Higher Heating Capacity is available.
 3. Specifications are subject to change.

